

WILDFIRES. EARTHQUAKES. PANDEMICS. FLOODS.

LET'S KEEP OREGON SAFE

Central Oregon, Oregon, and the Pacific Northwest are facing growing threats from natural disasters such as wildfire, flooding, and pandemics, as well as the anticipated Cascadia Subduction Zone earthquake.

Redmond, Oregon will play a significant role in rescue and recovery operations for major statewide disasters, yet the region lacks a dedicated multi-agency coordination center for emergency operations or adequate training facilities for large scale emergency incidents.

CORE3 will be a dedicated, multi-agency coordination center and collaborative training facility for local, state, and federal personnel.



CORE3

Central
Oregon
Ready
Responsive
Resilient

For more information,
please visit core3center.org

VISION

SHORT TERM (PHASE 1)

- Emergency Coordination Center/classroom facility
- Emergency Vehicle Operator Course (EVOC) and drivers skill pad
- Fire tower and burn building

LONG TERM

- Administration Building and Flexible Classrooms
- High Bay/Indoor Drill and Training Space
- Gun Range
- Urban Search & Rescue Prop
- Class A Burn Building; 2-story
- Drill Tower Building; 4-story with Class B burn props
- Shoot House/Reconfigurable Maze (simulations facility)
- Virtual de-escalation training
- Train car derailment and rescue prop
- Off-road driving course
- Tactical/street grid
- Wildland fire training
- Vehicle extrication prop
- Fire drafting pit - fire truck pump certification
- Rescue - confined space & trench prop
- ARF - Aircraft Rescue and Fire Fighting prop
- Emergency Medical Technician (EMT) Lab
- Roof training prop - Fire, SWAT/ Rappelling, Smoke, etc.
- Continuation of government functions
- Emergency supply cache

CORE3 PARTNERS

- CENTRAL OREGON COMMUNITY COLLEGE
- CENTRAL OREGON FIRE MANAGEMENT SERVICE
- CENTRAL OREGON INTERGOVERNMENTAL COUNCIL
- CITY OF BEND FIRE & RESCUE
- CITY OF BEND POLICE DEPARTMENT
- CITY OF MADRAS
- CITY OF REDMOND
- CITY OF REDMOND AIRPORT
- CITY OF REDMOND POLICE DEPARTMENT
- CROOK COUNTY
- CROOK COUNTY EMERGENCY MANAGEMENT
- DEPARTMENT OF PUBLIC SAFETY STANDARDS & TRAINING
- DESCHUTES COUNTY
- DESCHUTES COUNTY 911
- DESCHUTES COUNTY EMERGENCY MANAGEMENT
- DESCHUTES COUNTY SHERIFF'S OFFICE
- GOVERNOR'S REGIONAL SOLUTIONS
- JEFFERSON COUNTY
- JEFFERSON COUNTY EMERGENCY MANAGEMENT
- JEFFERSON COUNTY FIRE & EMS
- JEFFERSON COUNTY SHERIFF'S OFFICE
- OREGON DEPARTMENT OF FORESTRY
- OREGON DEPARTMENT OF TRANSPORTATION
- OREGON EMERGENCY MANAGEMENT
- OREGON STATE FIRE MARSHAL
- OREGON STATE POLICE
- REDMOND FIRE & RESCUE
- SISTERS-CAMP SHERMAN FIRE DISTRICT

PHASE 1

\$50 MILLION

of which, **\$25 MILLION** has already been secured

FUND CORE3. INVEST IN OREGON'S FUTURE.

DESIGN & ENGINEERING
12 MONTHS

LAND USE ENTITLEMENTS
12-18 MONTHS

GROUND BREAKING
TARGET: 30-36 MONTHS

FUNDRAISING
ONGOING



Central Oregon Ready Responsive Resilient

For more Information, please visit core3center.org

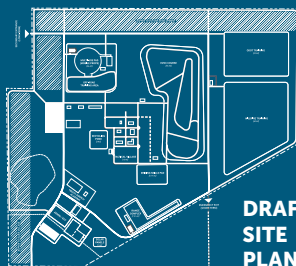

DRAFT SITE PLAN

